

3DRG Model Focus: Griffin Enright Point Dume



brian@3drg.com

Using two different processes in concert (FDM and PolyJet) 3DRG was able to deliver a very unique illuminated interactive model.

The home site was printed using the FDM process, while the home was printed using a translucent material and PolyJet Technology.

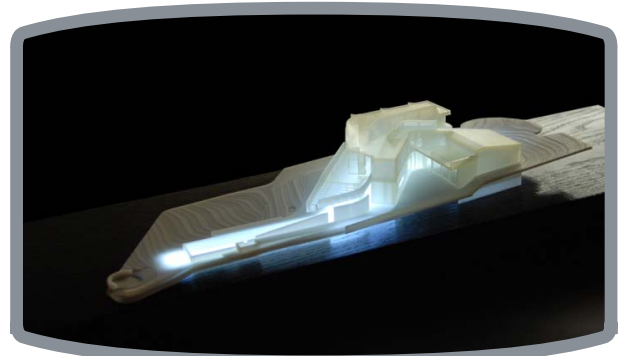

To reduce cost and add a level of interactivity to the model, the file was prepared in two pieces, allowing for interactive viewing of interior spaces.

The most challenging aspect of this project was exaggerating detailed features in the model. It was necessary to thicken them to make them printable without throwing off the overall proportions of the model.

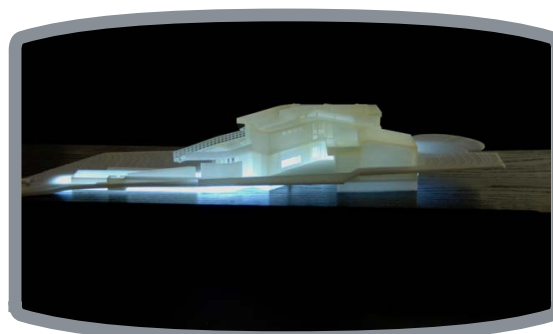

By combining different technologies, 3DRG can help you take your design to the next level.

